

4073/L

DELHI DEVELOPMENT AUTHORITY
CERTIFIED

Approved in 363rd Screening
Committee Meeting Dt. 11.09.2018
Vide Item No. 891/2018

Sign. Sd.
Name

एच० के० भारत
निदेशक (योजना) नरेला परियोजना
दिल्ली विकास प्राधिकरण
11वीं मंजिल, विकास मीनार
नई दिल्ली-110002

DEVELOPMENT AUTHORITY
COORDINATION UNIT
VERIFIED
This proposal was considered in the
Screening Committee Meeting held on 11-9-18
Vide Item No. 891/2018
Director (Arch.) Co-ord.

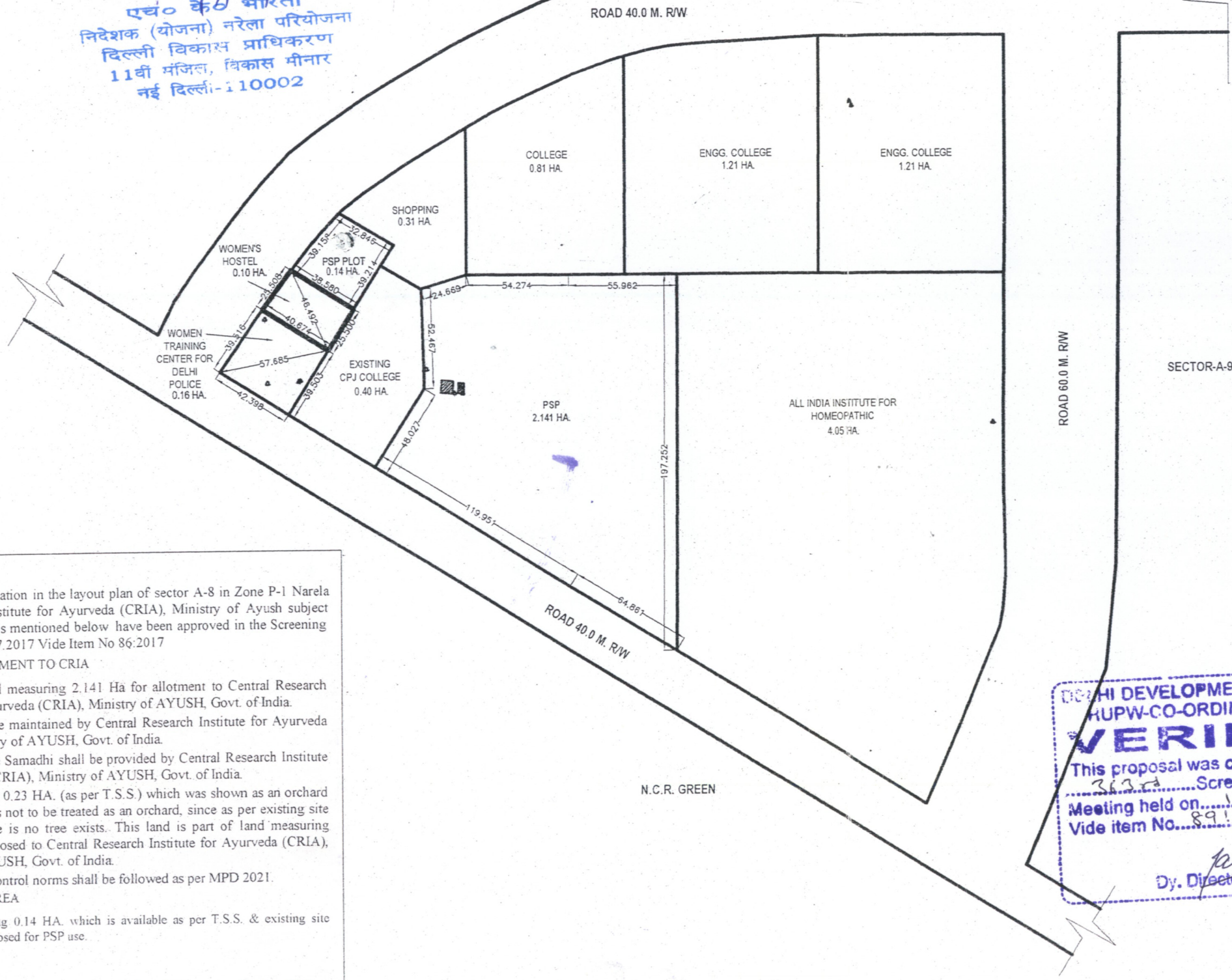

DELHI DEVELOPMENT AUTHORITY

दिल्ली विकास प्राधिकरण

KEY PLAN

निर्देशक नक्शा

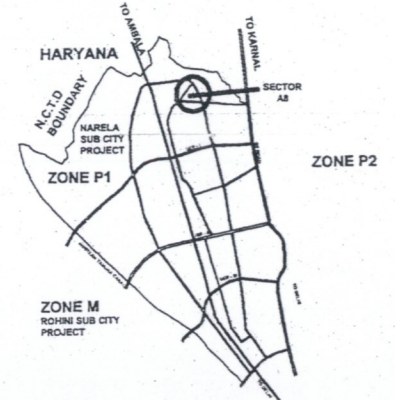

AREA STATEMENT (क्षेत्रफल वर्णन):

A. TOTAL AREA OF CRIA PLOT	2.141 HA.
i) AREA UNDER EXISTING SAMADHI	0.0043 HA. (42.79 sq.m.)
ii) *AREA UNDER BUILT-UP	0.0014 HA. (14.88 sq.m.)
B. TOTAL AREA OF PSP PLOT	0.14 HA. (1400 sq.m.)
* Status to be confirmed by LM Branch/DDA.	

LEGEND:

EXISTING TREES

NOTES:

- THE DRAWING IS BASED ON THE TOTAL STATION SURVEY PROVIDED BY THE EX. ENGINEER/ ND-4/DDA DATED 05.08.2017.
- ALL DIMENSIONS ARE IN METERS AND ONLY WRITTEN DIMENSIONS ARE TO BE FOLLOWED.
- EXACT SIZE, DIMENSIONS AND AREA WILL BE AS PER THE DEMARCATION AT SITE BY ENGINEERING WING.
- DEVELOPMENT CONTROL NORMS SHALL BE AS PER MPD-2021.
- SAMADHI SHALL BE MAINTAINED AS SAMADHI ONLY, AS PER THE DECISION WAS TAKEN IN RELIGIOUS COMMITTEE MEETING HELD ON 09.11.2006 AND THE SAME RECOMMENDATION HAS BEEN APPROVED BY THE HON'BLE L.G. DELHI VIDE LETTER NO.F.5 (121)/03/ LM/ NZ/ 301 DATED 26.03.2007

NOTE:

THE PROPOSAL WAS APPROVED IN THE 363RD SCREENING COMMITTEE DATED 11.09.2018 VIDE ITEM NO. 89:2018 WITH THE OBSERVATION THAT THE AREA MARKED FOR WOMEN TRAINING COLLEGE SHALL BE USED FOR PUBLIC SEMI-PUBLIC (PSP) FACILITIES.

FILE NO. (निसिल संख्या): F.15(161)2002/NP

MODIFIED PART LAYOUT PLAN OF SECTOR-A-8, ZONE-P1, NARELA FOR LAND ALLOTMENT TO THE CENTRAL RESEARCH INSTITUTE FOR AYURVEDA, M/O AYUSH

DRAWING NO. (ड्रॉइंग संख्या): VS/NARELA/P1/A8/1

PLANNING ASSISTANT योजना सहायक	ASSTT. DIR. (PLG.) सहायक निदेशक (योजना)	NORTH (उत्तर) ←
DY. DIR. (PLG.) उप-निदेशक (योजना)	DIRECTOR (PLG.) निदेशक (योजना)	SCALE (पैमाना): 1:2500
		DATE (दिनांक) JULY, 2017

NARELA PROJECT

नरेला परियोजना

NOTE:

The Proposal of modification in the layout plan of sector A-8 in Zone P-1 Narela for Central Research Institute for Ayurveda (CRIA), Ministry of Ayush subject to the conditions which is mentioned below have been approved in the Screening Committee held on 21.07.2017 Vide Item No 86:2017

A. LAND FOR ALLOTMENT TO CRIA

- To provide land measuring 2.141 Ha for allotment to Central Research Institute for Ayurveda (CRIA), Ministry of AYUSH, Govt. of India.
- Samadhi is to be maintained by Central Research Institute for Ayurveda (CRIA), Ministry of AYUSH, Govt. of India.
- Approach to the Samadhi shall be provided by Central Research Institute for Ayurveda (CRIA), Ministry of AYUSH, Govt. of India.
- Area measuring 0.23 HA. (as per T.S.S.) which was shown as an orchard in layout plan is not to be treated as an orchard, since as per existing site condition there is no tree exists. This land is part of land measuring 2.141 HA. Proposed to Central Research Institute for Ayurveda (CRIA), Ministry of AYUSH, Govt. of India.
- Development control norms shall be followed as per MPD 2021.

B. PLOT FOR PSP AREA

- Plot measuring 0.14 HA. which is available as per T.S.S. & existing site condition is proposed for PSP use.

Plg. Asstt. Asstt. Dir. (Plg.) Dy. Dir. (Plg.) Director (Plg.)

DELHI DEVELOPMENT AUTHORITY
RUPW-CO-ORDINATION UNIT
VERIFIED
This proposal was considered in the
363rd Screening Committee
Meeting held on 11-9-18
Vide item No. 891/2018
Dy. Director (Arch.) Co-ordn.